

(1) SMR Code	(2) Federal Stock Number	(3) DESCRIPTION	(4) UNIT	(5) Qty	(6) 30-day DS maint	(7) 30-day GS maint	(8) 1-yr Depot	(9) Illustration	(10) of inc. allowance	(11) allowance	(12) alw	(13) per	(14) 100	(15) equip	(16) 100	(17) Figure	(18) No.	(19) Item
-----------------	-----------------------------	--------------------	-------------	------------	------------------------	------------------------	-------------------	---------------------	---------------------------	-------------------	-------------	-------------	-------------	---------------	-------------	----------------	-------------	--------------

Reference Number & Mfr. Code

Usable On Code

(a) (b) (c) (a) (b) (c) gcy

0802-CLUTCH AND CLUTCH CONTROLS--CONTINUED

P-O	5305-068-0506	SCREW, CAP, HEXAGON: LOOP CLAMP MS90726-6 (96906)	A	EA	3	*	*	*	*	*	*	6	10	57				11	
P-O	5310-959-7600	NUT, SELF-LOCKING: LOOP CLAMP SCREW MS1922-5 (96906)	A	EA	3	*	*	*	*	*	*	6	10	57				12	
P-O	4730-277-5553	ELBOW, PIPE: HOSE TO TRANSFER MS1952-2 (96906)	A	EA	1	*	*	*	*	*	*	4	10	57				13	
P-O	4720-318-0974	HOSE ASSEMBLY, NONMETALLIC: AIR HOSE TO TRANSFER 8330260 (19207)	A	EA	1	*	*	*	*	*	*	8	10	57				14	
P-O	4730-832-7012	CONNECTOR, AIR LINE: 8327012 (19207)	A	EA	2	*	*	*	*	*	*	4	10	57				15	
P-O	2530-832-7011	HOSE ASSEMBLY, RUBBER: AIR FORWARD AND REVERSE TRANSMISSION TO TRANSFER CASE 8327011 (19207)	A	EA	1	*	*	*	*	*	*	8	10	57				16	
X2-O		PLATE: CLAMP TO TRANSFER 8327010 (19207)	A	EA	1	*	*	*	*	*	*					57		17	
NON-ILLUSTRATED																			
P-F	2520-832-7018	LOCK: BEARING RETAINING WASHER BOLT 8327018 (19207)	A	EA	1	*	*	*	*	*	*	6	10						
P-F	4710-277-3527	TUBE, COPPER: TRANSFER DECLUTCH PIPING 230523 (62508)	A	FT	V	*	*	*	*	*	*	6	10						
P-F	5305-042-8997	SCREW, CAP, HEXAGON HEAD: TRANSFER CASE 7521338 (19207)	A	EA	1	*	*	*	*	*	*	6	10						
P-F	2520-737-5247	KIT, REPAIR, TRANSFER: 7375247 (19207) CONSISTING OF: 3-SHIM: 0.003 REAR OUTPUT SHAFT REAR BEARING 7375297 (19207) 3-SHIM: 0.005 REAR OUTPUT SHAFT REAR BEARING 2803N1470 (78500) 1-SHIM: 0.030 REAR OUT PUT BEARING SHAFT 2803P1472 (78500) 3-SHIM: 0.003 REAR BEARING COVER 7346751 (19207) 4-SHIM: 0.005 REAR BEARING COVER 7346752 (19207) 1-SHIM: 0.030 REAR BEARING COVER 7346753 (19207)	A	EA	1	*	*	*	*	*	*	15	100						
																52		10	
																52		10	
																52		10	
																52		13	
																52		13	
																52		13	

Current part is item (14) on diagram. Available at www.oshkoshequipment.com

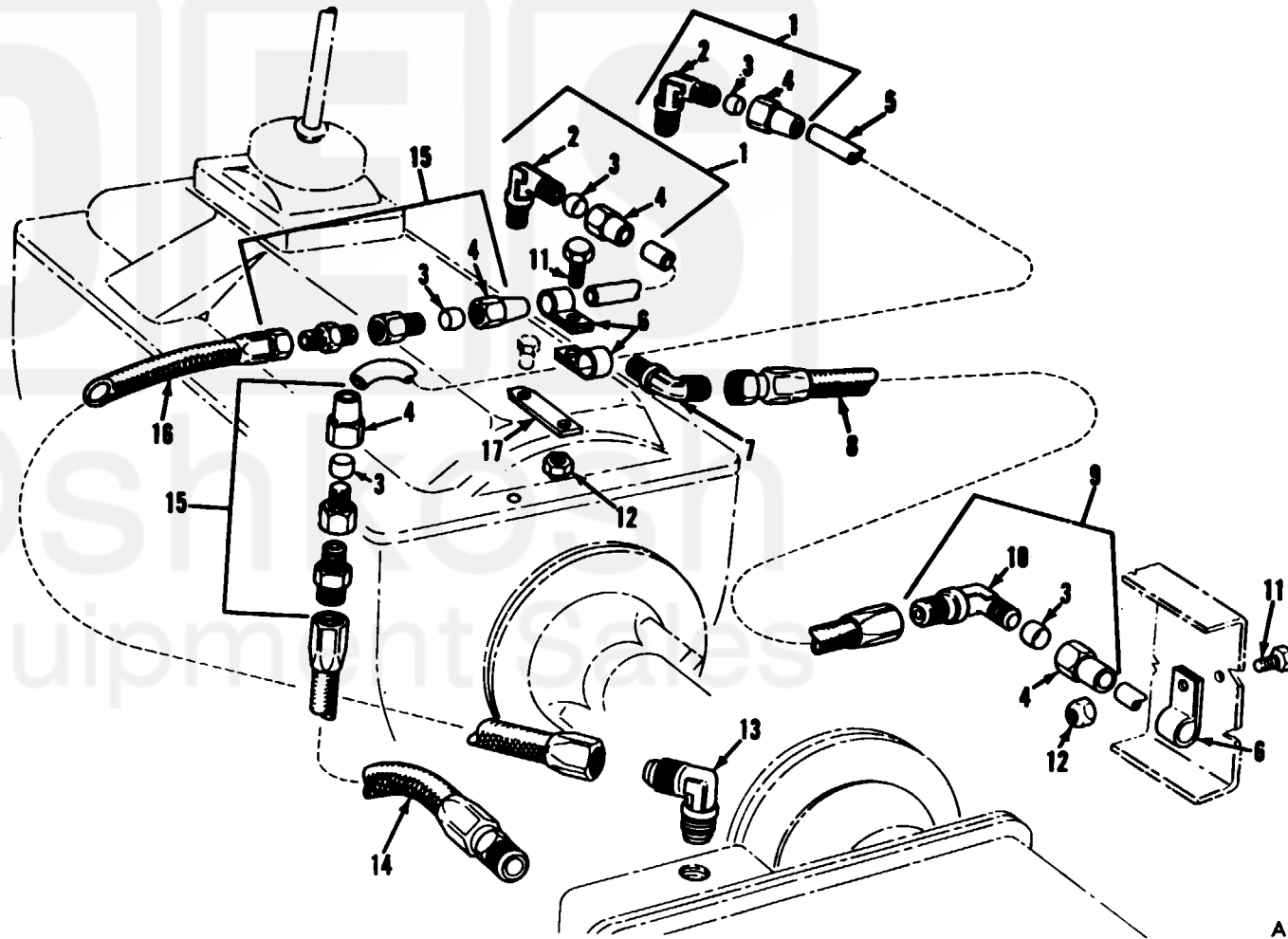

AT 47197

Figure 57. Declutch control piping.

Current part is item (14) on diagram. Available at www.oshkoshequipment.com